

THESE DRAWINGS ARE NOT AS-BUILT. DO NOT SCALE THESE DRAWINGS. THESE DRAWINGS REPRESENT THE DESIGN INTENT AND SHALL BE USED IN CONSTRUCTION OF THE PROJECT. ANY DEVIATIONS FROM THESE DRAWINGS SHALL BE THE RESPONSIBILITY OF THE CONTRACTOR. THE CONTRACTOR SHALL VERIFY ALL DIMENSIONS AND CONDITIONS PRIOR TO CONSTRUCTION. ANY CHANGES TO THESE DRAWINGS SHALL BE THE RESPONSIBILITY OF THE CONTRACTOR. THE CONTRACTOR SHALL MAINTAIN THE PROPERTY OF THE ARCHITECT. ANY REPRODUCTION OR DISTRIBUTION OF THESE DRAWINGS WITHOUT THE WRITTEN PERMISSION OF THE ARCHITECT IS STRICTLY PROHIBITED. THESE DRAWINGS SHALL CONSTITUTE EVIDENCE OF THE ARCHITECT'S DESIGN AND SHALL BE USED AS SUCH. THE ARCHITECT'S DESIGN SHALL BE THE BASIS FOR ALL CONSTRUCTION. THE ARCHITECT SHALL NOT BE RESPONSIBLE FOR ANY INADEQUATE INFORMATION AND OBSERVATION OF THE CONSTRUCTION PROCESS.

Consultants:

Stamps:

Project:

UCSB FACULTY HOUSING RENOVATION

UCSB
SANTA BARBARA, CALIFORNIA

PRELIMINARY 50% CD SET

NOT FOR CONSTRUCTION

Drawing Title:

ADD-ALT DETAILED TRELLIS PLANS

Revision Number Date

Issued for UCSB review 4/10/2009

Fremer Project No: 07006.00

Approved: _____

Drawn By: _____

Scale: as noted

Date: FEBRUARY II, 2009

Sheet:

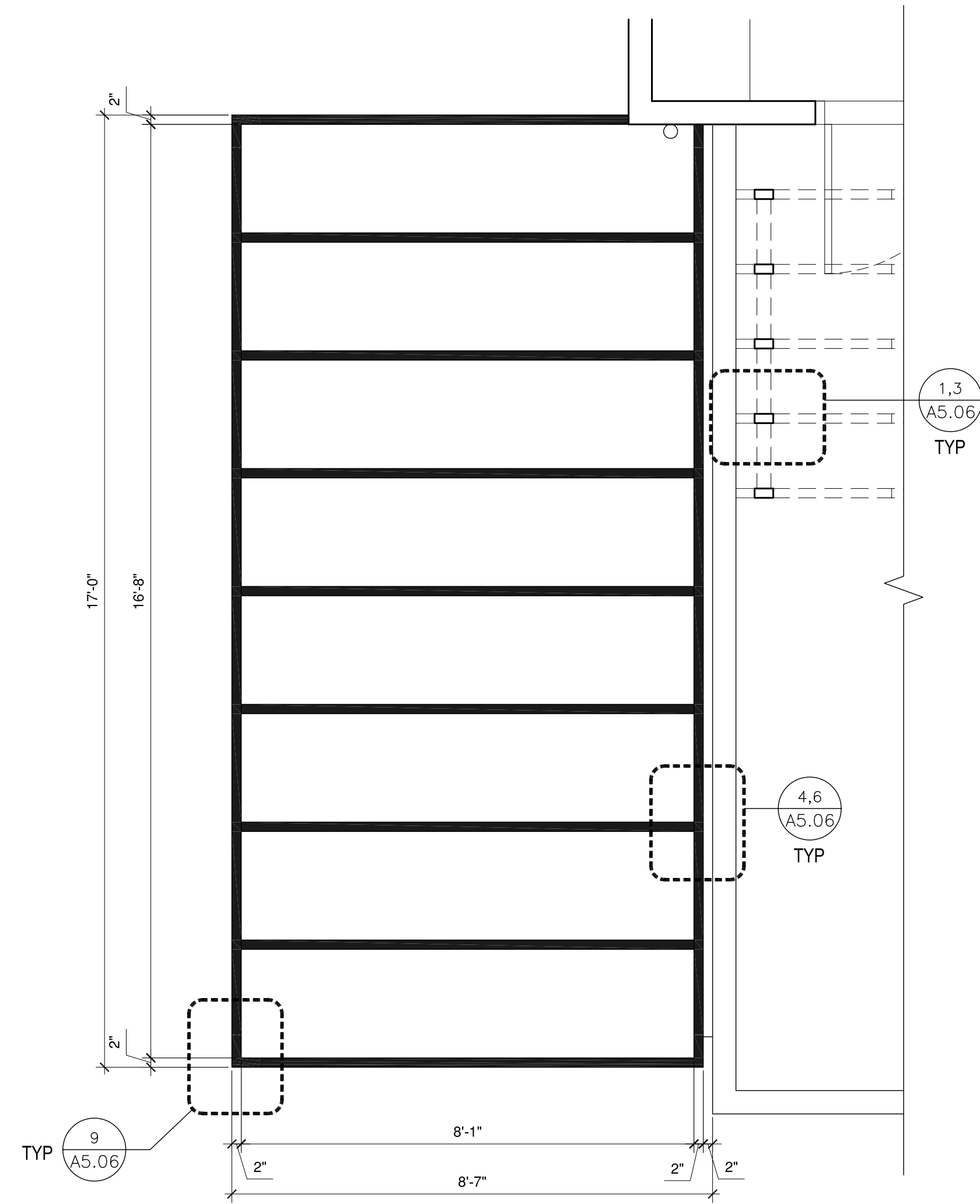

C DETAILED ADD ALT 1 CARPORT TRELLIS
SCALE: 1/2"=1'-0"

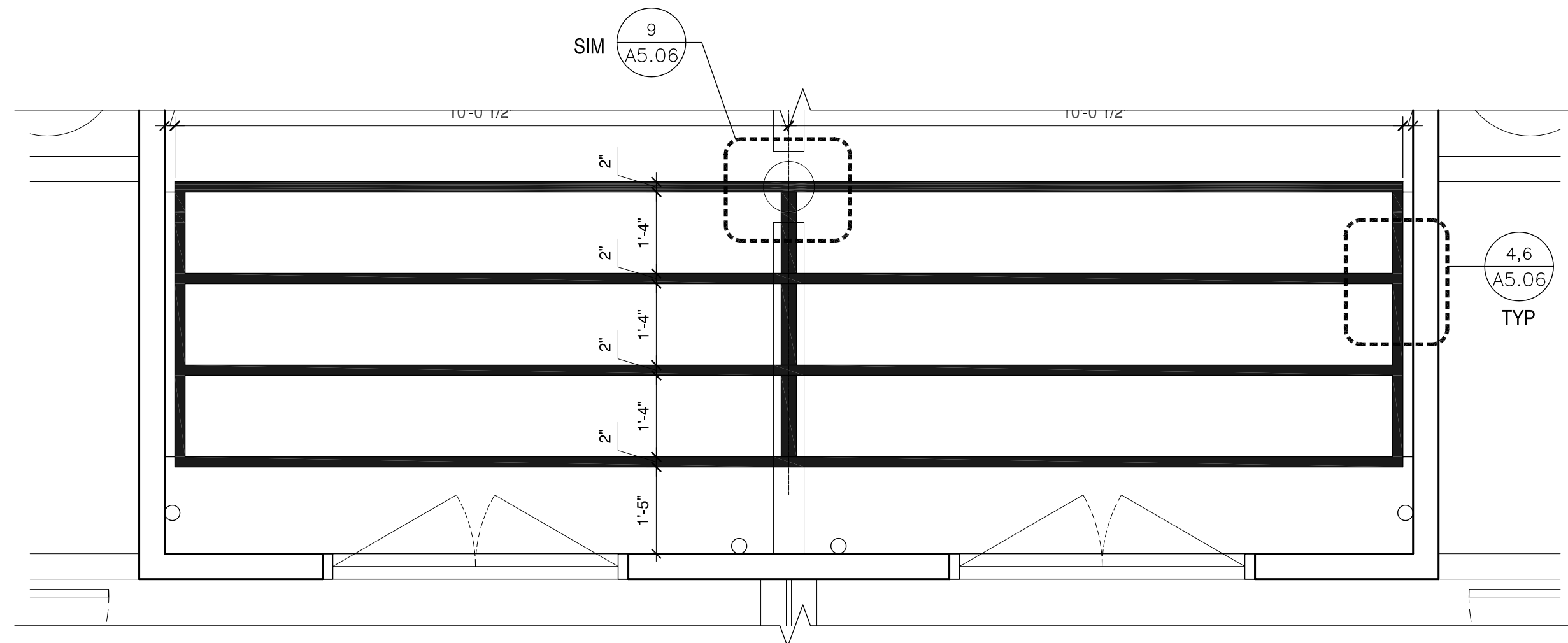

B DETAILED ADD-ALT 2 1ST FLOOR PATIO TRELLIS
SCALE: 1/2"=1'-0"

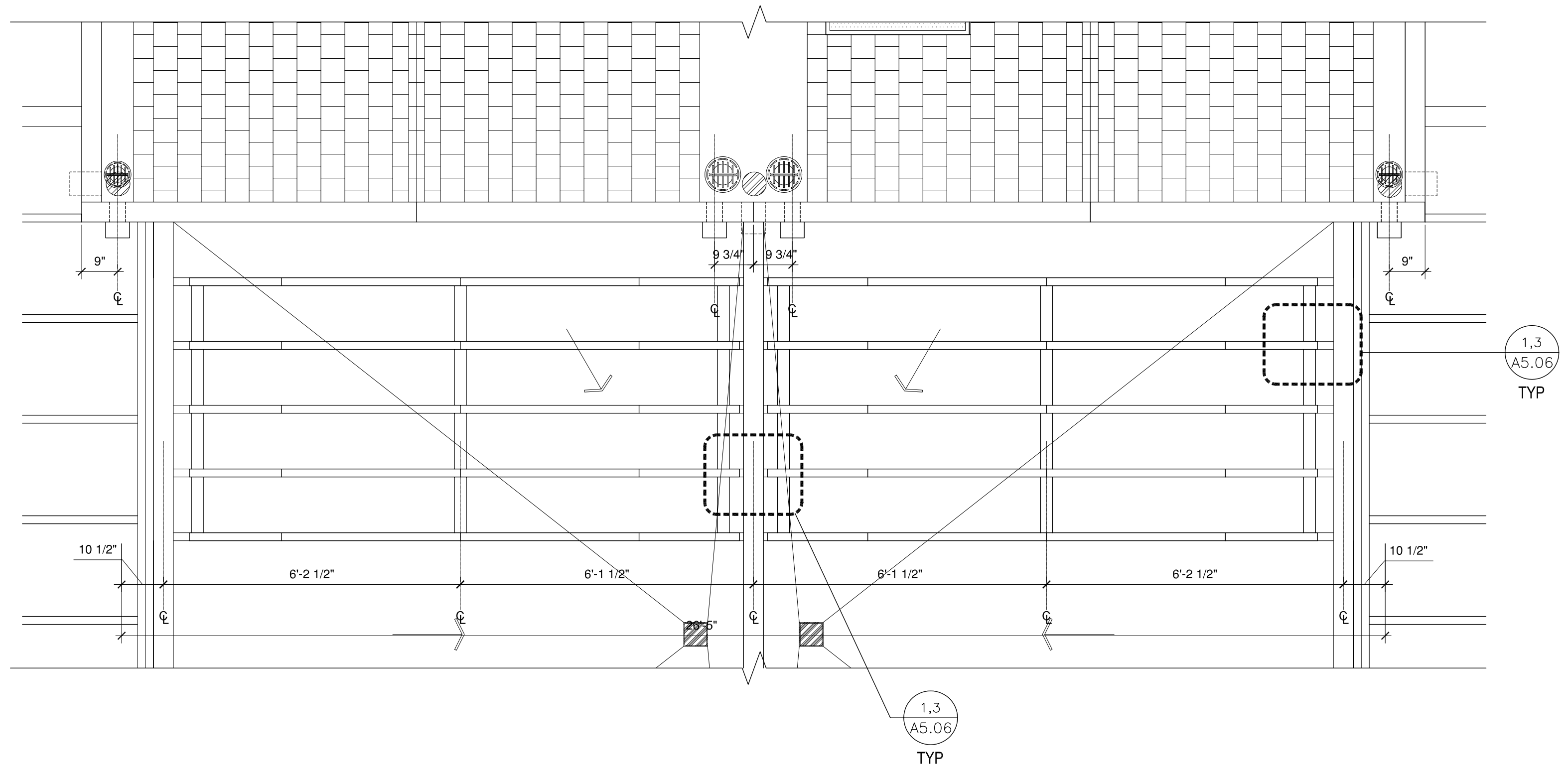

A DETAILED ADD-ALT 3 2ND FLOOR DECK TRELLIS
SCALE: 1/2"=1'-0"